



RESCUE SET MANUAL

SINGING ROCK Rescue Set



ADDITIONAL EQUIPMENT

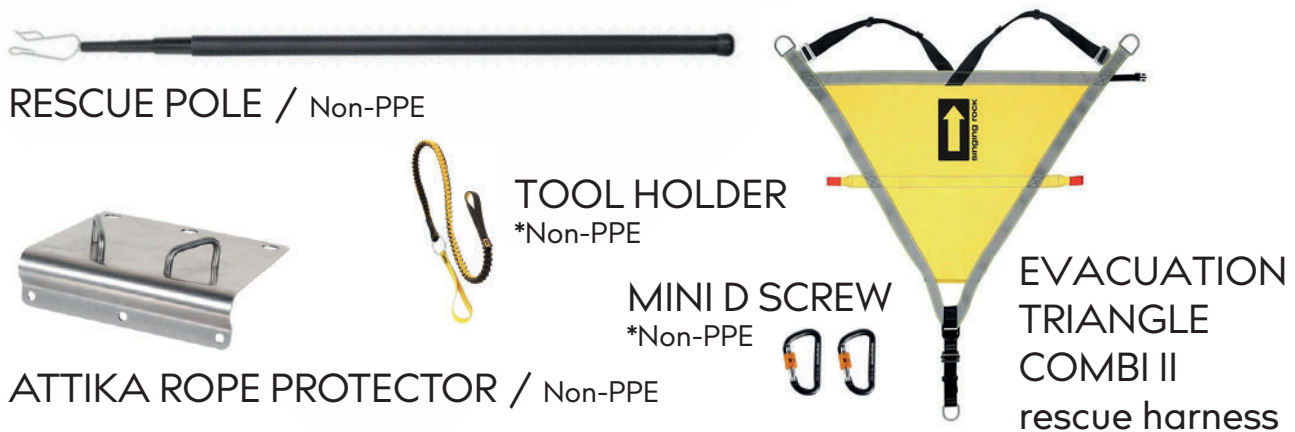

PURPOSE

The purpose of the Rescue Set is to lift up the casualty, to release the primary safety system (lanyard/connector) and then lower the casualty to a safe location.

Step 1 - Lifting:

Lifting up with the Rescue Ratchet.



Step 2 - Descend:

Pull the descender handle & control upper rope for descend of the casualty.

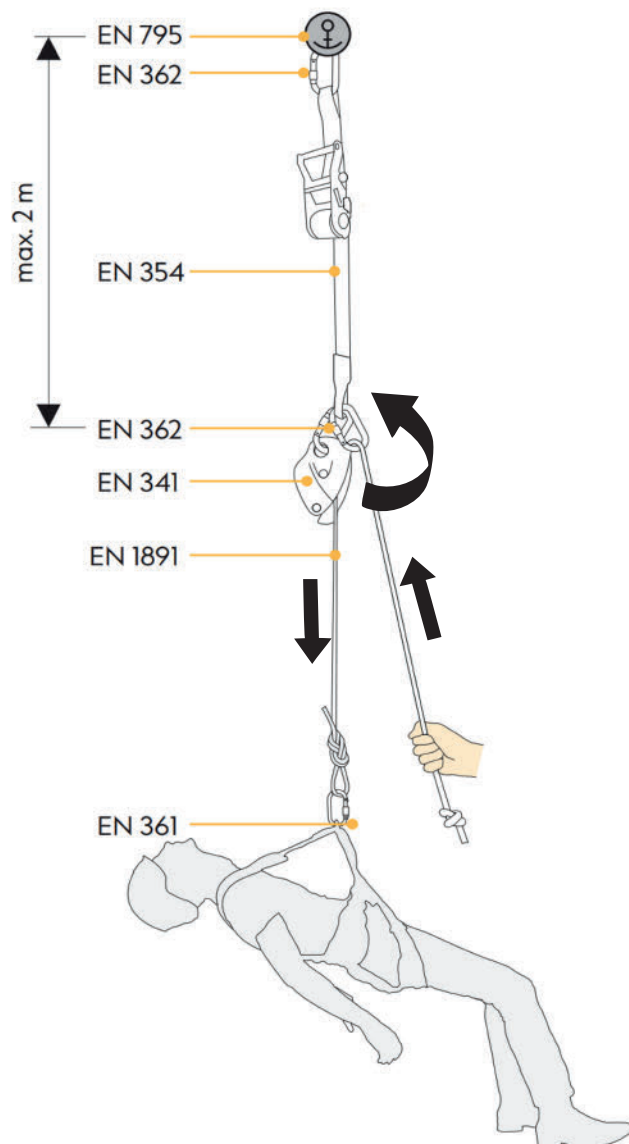

STEP-BY-STEP GUIDE

Step 1 – Anchor set up

Install Steel Lanyard on the anchor point.

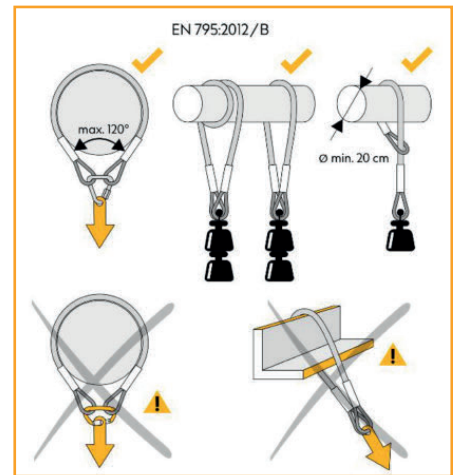
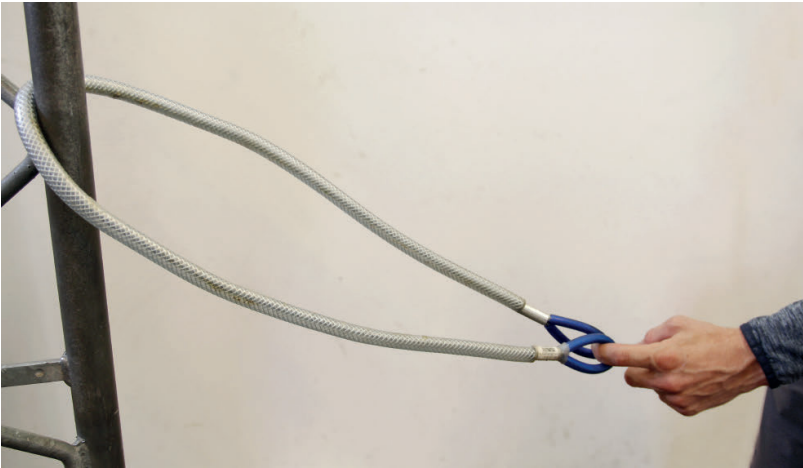

Over-edge rescue

Place the Atika on the edge, secure it against the fall and install the Rescue Ratchet over.



Step 2 - Connection of Rescue Ratchet

Connect the Steel Oval connector with the Rescue Ratchet into the anchor point.

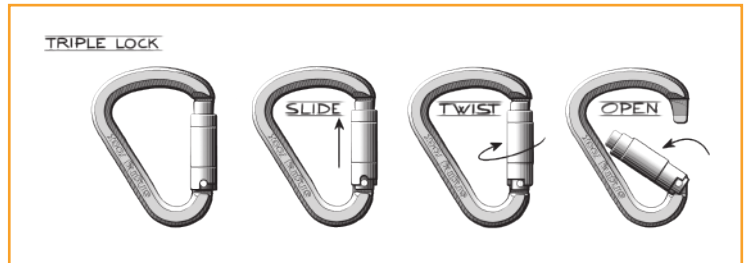
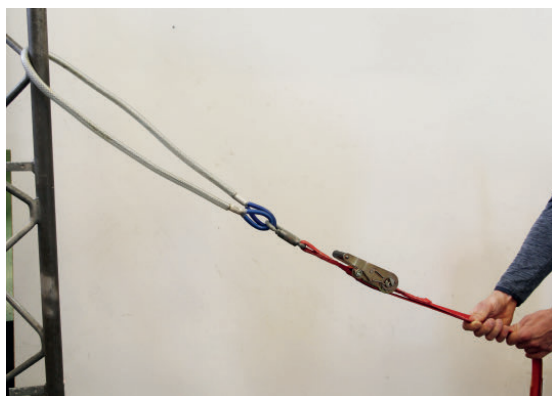

Step 3 – Rope loosen for connection of the casualty

Push the cam for rope loosen.

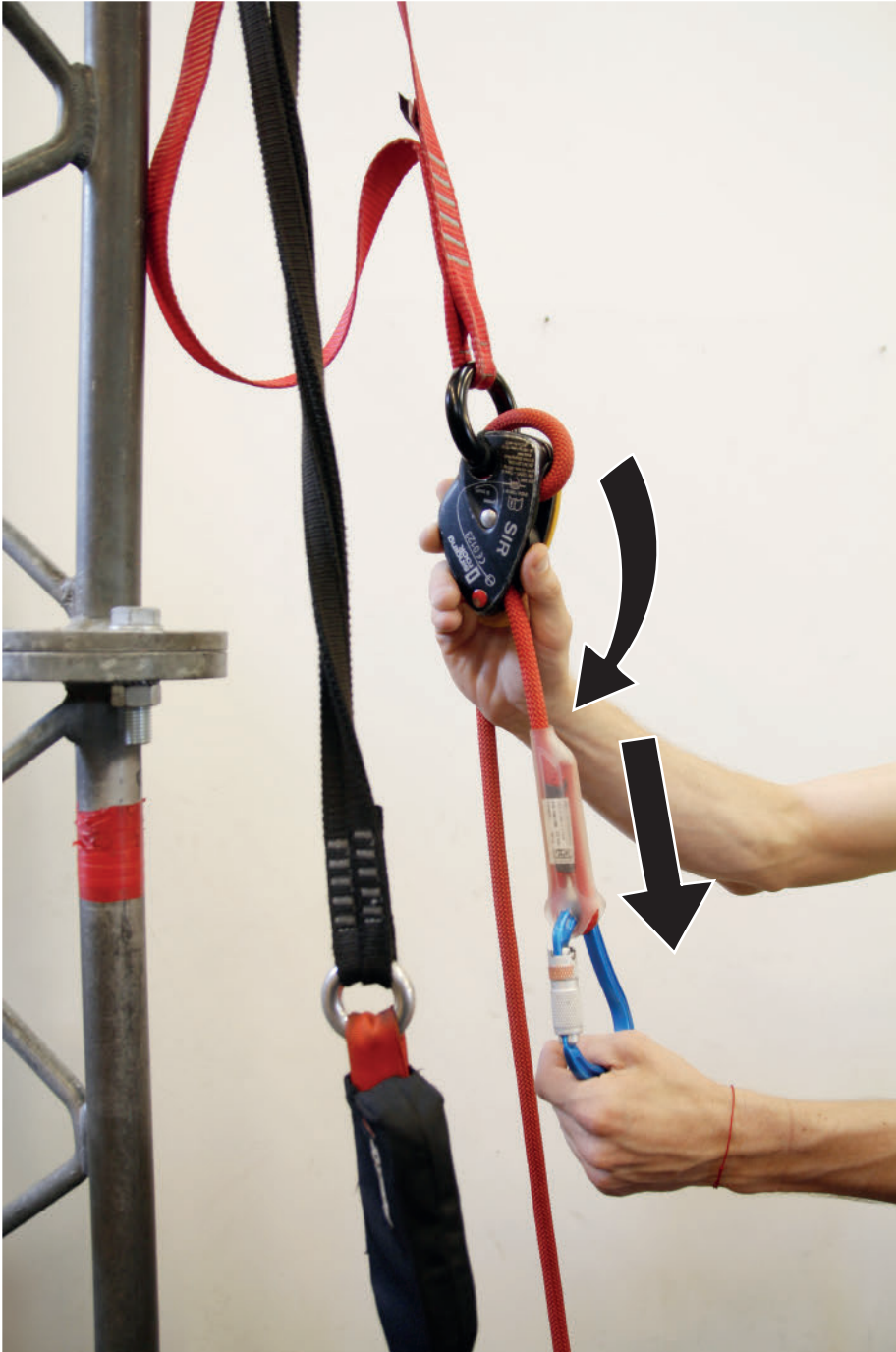

Step 4 – Connection of the casualty

Connect the carabiner into casualty's A point.
Possibility of using the Rescue pole.

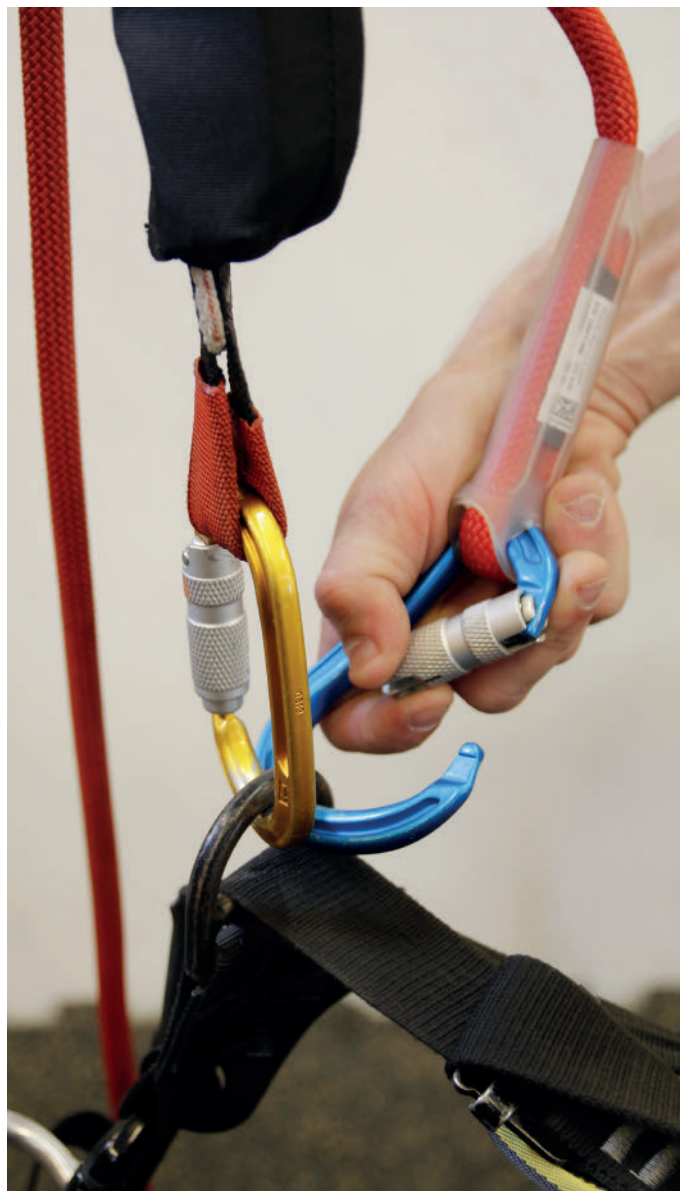

Step 5 – Pulling of extra rope

Pull extra rope bellow the descender.

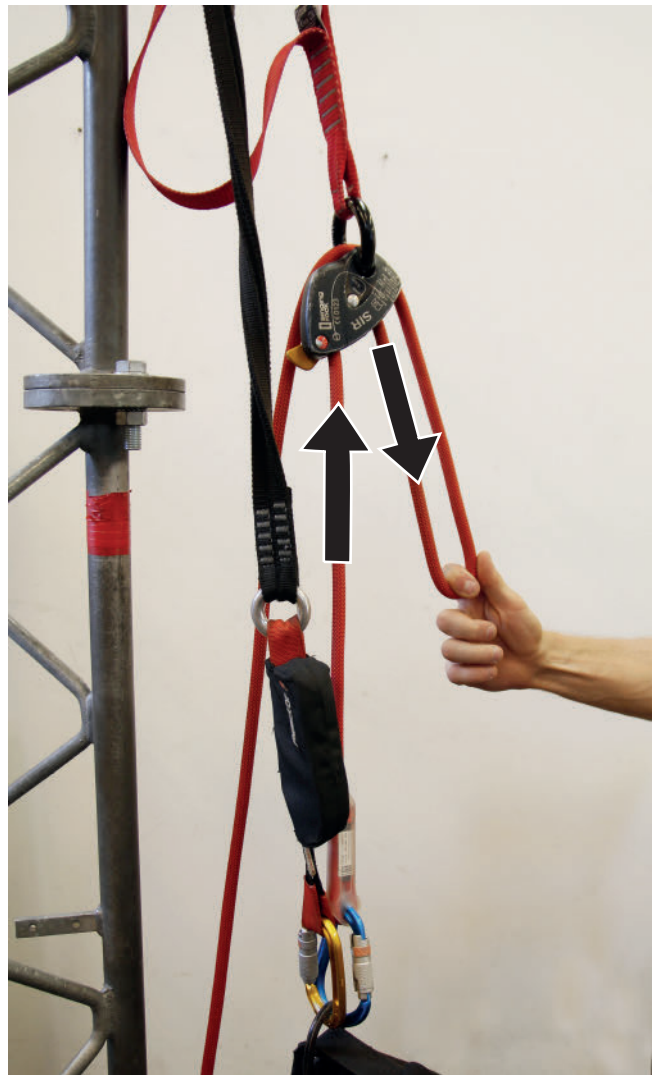

Step 6 - Lifting with Rescue Ratchet

Lift up the person with the Rescue Ratchet, so you can release casualty's primary system.

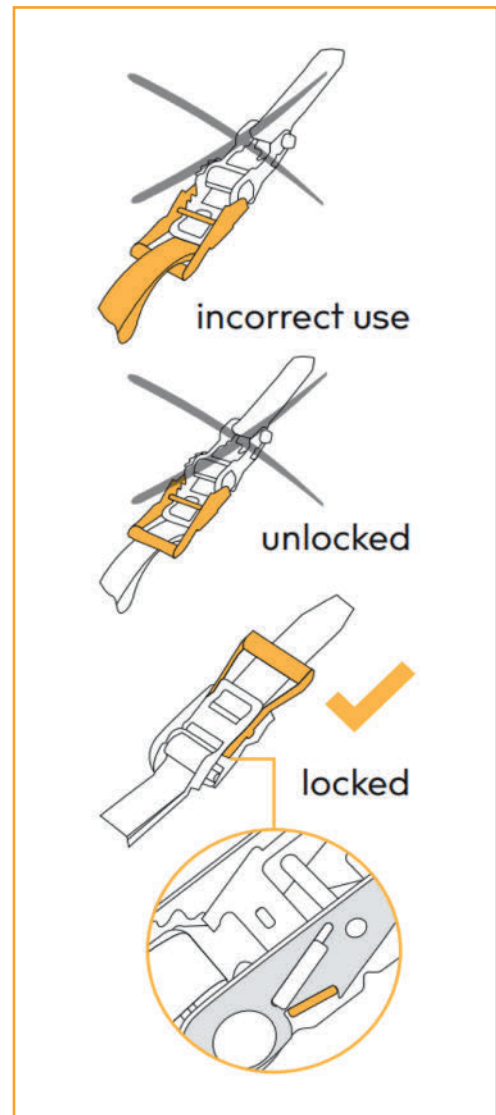

Step 7 – Primary system release

Release of casualty's primary system (e.g. connector unclipping)



Step 8 – Descend of the victim

Pull the handle and control upper rope with your hand.

Lower the casualty on the ground to the safe place and provide first aid to the victim on the ground.

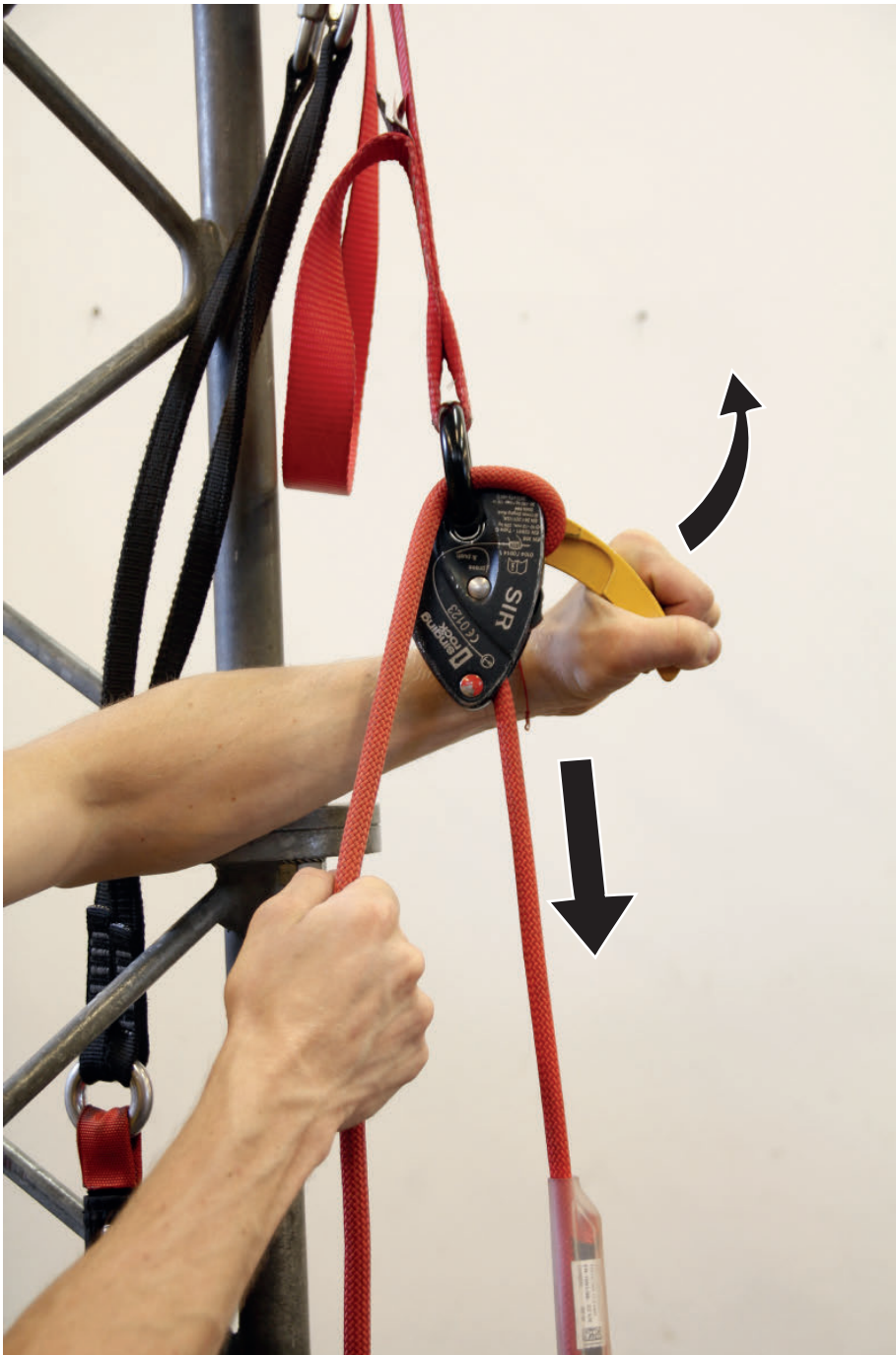

Video tutorial

www.singingrock.com/rescue-set



Watch Rescue Set in use!

